

AGDL-AGDS/AGS-090

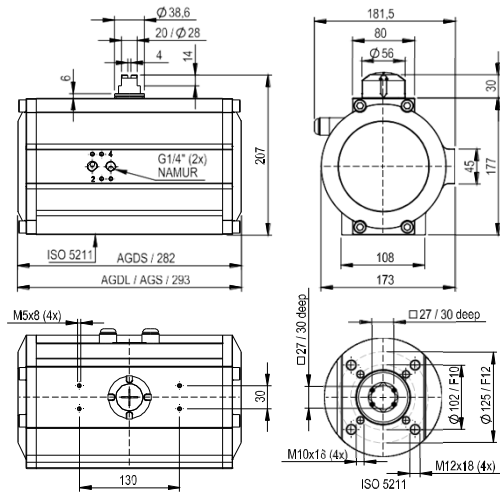

End position adjustment

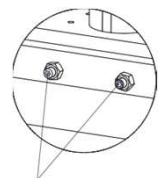

Adjusting screws, between +5° and -3°

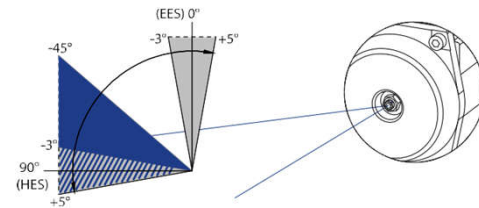

Optional: Stroke Limitation caps between +5° and -45° for the actuator sizes AGD/AGS-004-600.

The pivoting angle can be adjusted in both end positions in pressure free conditions between +5° and -3°.

Torque-table double-acting actuator (Nm)

	Control Pressure Pst (bar)										
	2	2.5	3	3.5	4	4.5	5	5.5	6	7	8
AGDL - 090	184.9	231.1	277.3	323.5	369.7	415.9	462.2	508.4	554.6	647.0	739.4
AGDS - 090											

Torque-table single-acting actuator (Nm)

Actuator Type	No. of Springs	Md F (Nm)		Pneumatic Applied Torque Md (Nm) at Minimum Control Pressure Pst (bar)																					
				2		2.5		3		3.5		4		4.5		5		5.5		6		7			
		min	max	min	max	min	max	min	max	min	max	min	max	min	max	min	max	min	max	min	max	min	max		
AGS 090	4	72.50	109.00	76	112	122	159																		
	5	90.63	136.25	49	94	95	140	141	187																
	6	108.75	163.50			68	122	114	169	160	215														
	7	126.88	190.75					87	150	133	197	179	243												
	8	145.00	218.00							106	179	152	225	198	271										
	9	163.13	245.25									124	207	171	253	217	299								
	10	181.25	272.50											143	235	190	281	236	327						
	11	199.38	299.75													162	263	209	309	255	355				
	12	217.50	327.00															181	291	228	337	320	430		

Technical developments & alterations are reserved. 04/2022 GM APE Automation (India) Pvt. Ltd.



Weight, air consumption

Actuator type	AGDL	AGDL	AGS
Weight (kg)	10.40	9.90	12.9
Volume (l) Double-stroke	5.20	4.95	2.60

Control pressure

Control pressure: 2 - 8bar
Control medium/
quality: Filtered air minimum acc.
to DIN/ISO 8573-1 Class 4

Switch time (sec*)

AGDL	AGDS	AGS	
		0 - 90°	90 - 0°
1.8	2.0	1.4	1.3

Ambient temperature

Standard	- 35°C to +80°C
High-temp (HT)	- 15°C to +140°C
Low-temp (TT)	- 50°C to +70°C

Optional extras

- Other housing coatings
- Pinion: Stainless Steel AISI 304 or 316
- 180° actuator: rotation 180° to 120° adjustable
- 3 - position actuator: 0° - 90° - 180° / 0° - 45° - 90°

*Quoted switch times are guidelines for a double-stroke at 5 bar control pressure and at 50% rated loading. With high valve actuating speeds, potentially dangerous large braking forces can arise in the actuator end positions. Tip: Throttle the exhaust air or select a larger actuator. Single Action actuators with 12 springs.

Ordering code

AGDL - 090 / 090 - V27 - H
AGDS - 090 / 090 - V27 - H
(see assembly variants)
AGS - 090 / 090 - 06* - V27 - H
(see assembly variants)
*The number of springs (4 up to 12pcs.) must be matched to the control pressure beforehand
AGDL = Double acting with spring end caps
AGDS = Double acting with short end caps
AGS = Single acting with spring

Materials

- Housing: Al-alloy, anodised, outside PP-coated
- Caps: Al-alloy, PP-coated
- Piston: Al-alloy
- Pinion: Al-alloy, hard-anodised
- Namur shaft: SS316
- Seals: NBR (Perbunan)
- Bearing: Plastic, POM
- Screws: Stainless steel 1.4301

Technical developments & alterations are reserved. 04/2022 GM APE Automation (India) Pvt. Ltd.